

Parks & Recreation Committee Meeting

*Wednesday, April 8, 2026 – 5:00 PM,
Menominee County Annex
S904 US Hwy 41, Stephenson, MI 49887
(906) 863-9648*

AGENDA

- A. Call to Order
- B. Pledge of Allegiance
- C. Roll Call (Branz, Betzinger, Desjarlais, Peterson, Phelps, Smith, & Westrich)
- D. Approval of the Agenda
- E. Approval of the Previous Minutes (March 2, 2026)
- F. Public Comment (*Statements, not debate, limited to 5 minutes on agenda items only*)
- G. Business
 - FY2026 Budget Reports – March 31, 2026
 - County Administrator Report
 - Park Ranger Report
 - Shakey Lakes – Beach Access & Erosion Control Project
 - Shakey Lakes – Music in the Park
 - Shakey Lakes – Ski Show Event
 - Stony Point – Boat Ramp
 - Other Business
- H. Public Comment (*Limited to 5 Minutes*)
- I. Committee Comments
- J. Adjourn



NEXT AGENDA ITEM

MENOMINEE COUNTY PARKS & RECREATION COMMITTEE

Minutes of Meeting

March 2, 2026

DRAFT

The Menominee County Parks & Recreation Committee met on March 2, 2026 at 5:00 PM at the Menominee County Annex, Stephenson, MI.

I. Call to Order by Adm. Carviou at 5:00 PM.

II. Pledge of Allegiance recited by those in attendance.

III. Roll Call

Present – Branz, Betzinger, Desjarlais, Peterson, Phelps, Smith, Westrich & Adm. Carviou.

IV. Approval of the Agenda

M/Branz, S/Westrich to approve the agenda. Vote taken. MOTION CARRIED UNANIMOUSLY.

V. Approval of Previous Minutes (Feb 2, 2026)

M/Betzinger, S/Westrich to approve previous minutes, from Feb 2, 2026. Vote taken. MOTION CARRIED UNANIMOUSLY.

VI. Public Comment on Agenda Items – None.

VII. Presentations – None.

VIII. Business

➤ **FY2026 Budget Reports – January 31, 2026**

○ Still not a lot of activity in late winter

➤ **County Administrator Report**

○ Started accepting online reservations March 2. As of 4pm, received 949 reservations, totaling \$126,110. 2025 was at 974 by end of day, (2.6% less but not through the whole day yet), 18% increase in revenue due to price increases. Smooth process thus far.

○ Seasonal reservations due last Friday: 3 sites not returning, 1 no response. 28 or so left at Shakey, 1 at Kleinke.

○ Shakey Lakes license updated.

- Seasonal Staff: 3 returning, 3-4 left to fill. Target to fill all by mid-April
- County Board approved:
 - membership into MARVAC
 - Quote with Piche for tree removal
 - Mason Park Road project - on agenda for MCRC
 - The County Board approved removing sites as discussed at prev. meeting
- County Board informed of proposed updates to brochures & maps
- Informed Staff that Parks office will be open 8am - 8pm (not 9a-9p)
- ATV/UTV ordinance, still in progress, will consult more with County legal
- Buildings and Ground Committee meeting this Wednesday
 - Received several quotes for dump trailer
 - Discussing skid steer for County to share, benefit Parks with different projects
 - Moving equipment around between County offices rather than buying new
- **Park Ranger Report - none.**
- **Shakey Lakes – Beach Access & Erosion Control Project**
 - Met with UP Engineers (UPEA) & Ayers Engineers to get proposals. Also looked into DNR grants available but too late for complete application. Plan to apply March 21, 2027 to allow more time for all aspects of the project. The State will contribute possibly up to 75%, especially if ADA accessible. Other helpful winning aspects discussed. Possibly include re-paving / re-surfacing of the parking lot. Engineers help put together the grant application and cost may be part of the grant process. Two to three phases to both engineering plans. The best case with the grant process is it won't be completed until 2028, realistically 2029.
 - Considerations:
 - Proposals with prices approximately, UPEA - \$26,000, Ayers - \$32,000.
 - Ayers took much more time to respond.
 - Could easily estimate over \$100,000 for full project cost. So far, \$20,000 spent already. Could even push costs higher through additions to the project.

- May still need to work on Shakey Lakes parking lot sooner regardless as it needs work done. Or may be best to see how it holds up through 2026 and make a decision in the fall.
 - MCRC can do crack sealing with summer help, they also can stripe it.
- M/Betzinger, S/Phelps - to Recommend to the County Board to fund the Shakey Lakes project as proposed and to enter into a contract with UP Engineers to complete Phase I to be paid out of the Designated Fund Balance. Vote taken. MOTION CARRIED UNANIMOUSLY.

➤ **Shakey Lakes – Music in the Park**

- August 8th. Musical act Neon Detour will perform for the same price as last year of \$1,400. The DJ & host will also do it for the same price as last year of \$100. Music act Marshall Star will perform for \$1,000, Music act Sunnyside (mother-daughter duo) will perform for \$500. A package deal for Marshall Star & Sunnyside is proposed at \$1,400. Music act Stranded does rock cover songs for \$1,500.
- M/Peterson, S/Smith to recommend to the County Board to book the DJ, Sunnyside and Stranded for \$2,100 (with Marshall Star as a backup). Vote taken. MOTION CARRIED UNANIMOUSLY.
- Also food trucks need to be contacted.
 - Adm. Carviou, Peterson & Betzinger will begin to follow-up on this.

➤ **West Shore Fishing Museum – Buildings & Grounds Custodian**

- Adm. and volunteer staff of the Museum are requesting the County to get more help with exhibits and bathrooms. Rangers and other seasonal staff can't devote enough time. Adm. proposes hiring someone to solely work 20 hours to do custodial work at this park. Position description presented to the Committee.
- M/Branz, S/Peterson to Recommend to the County Board to hire a Buildings & Grounds Custodian for the West Shore Fishing Museum. Vote taken. MOTION CARRIED UNANIMOUSLY.

➤ **Other Business**

- Adm. Carviou talked with representatives of Chappee Rapids about maintenance. The Historical Society there is asking the County to continue with maintenance. The committee will not make any recommendation.

IX. Public Comment

- Gary Peterson, Menominee. Camping at Shakey Lakes since 1999 and agrees with many changes except for elimination of parking lot camp sites. Our family & friends were disappointed with this. If your proposal is to redo the parking lot, then move the lot closer to the beach. Also the parking lot doesn't look as bad as stated by some on the Committee.
 - *Suggestion to add to earlier proposed grant to widen out the road*
- Debbie Smith of Fair Board - If you need a list of vendors for Music in the Park, let me know

X. Committee Comments

- None.

XI. Adjourn

- M/Betzinger, S/Westrich to Adjourn. Vote taken. MOTION CARRIED UNANIMOUSLY at 6:42 pm.

MEETING ADJOURNED

Reminder: Next meeting, April 8th at Menominee County Annex.

2026 Committee Meeting Schedule

All Meetings at 5:00pm on the First Monday of the month, except where noted

April 8 (Weds)	Menominee County Annex
May 4	Menominee County Annex
June 1	River Park
July 6	Shakey Lakes Park
Aug 3	Kleinke Park
Sept 9 (Weds)	Mason Park
Oct 5	Bailey Park
Nov 2	Menominee County Annex
Dec 7	Menominee County Annex



NEXT AGENDA ITEM

GL NUMBER	DESCRIPTION	2025-26	2025-26	YTD BALANCE	ACTIVITY FOR	AVAILABLE	% BDGT USED
		ORIGINAL BUDGET	AMENDED BUDGET	03/31/2026 NORM (ABNORM)	MONTH 03/31/26 INCR (DECR)	BALANCE NORM (ABNORM)	
Fund 208 - COUNTY PARKS							
Revenues							
Dept 000 - NONE							
208-000-581.00	HANNAHVILLE GRANTS - PARKS	0.00	6,000.00	6,000.00	0.00	0.00	100.00
208-000-614.00	PAID SHOWERS-KLEINKE	1,000.00	1,000.00	70.25	0.00	929.75	7.03
208-000-614.01	PAID SHOWERS-SHAKEY	2,750.00	2,750.00	164.75	0.00	2,585.25	5.99
208-000-642.00	FIREWOOD - SHAKEY LAKES	2,500.00	2,500.00	0.00	0.00	2,500.00	0.00
208-000-642.01	FIREWOOD-KLEINKE	2,500.00	2,500.00	465.00	0.00	2,035.00	18.60
208-000-651.00	DAILY PARK PASSES	22,500.00	22,500.00	2,877.57	1,389.00	19,622.43	12.79
208-000-651.01	ANNUAL PARK PASSES	45,000.00	45,000.00	12,149.35	8,750.00	32,850.65	27.00
208-000-653.01	CAMPING FEES - SHAKEY LAKES	115,000.00	115,000.00	63,030.00	61,005.00	51,970.00	54.81
208-000-653.02	CAMPING FEES - KLEINKE	70,000.00	70,000.00	48,600.00	46,800.00	21,400.00	69.43
208-000-653.03	CAMPING FEES - RIVER	3,000.00	3,000.00	500.00	320.00	2,500.00	16.67
208-000-653.04	RESERVATION FEES - COUNTY	27,500.00	27,500.00	10,520.00	9,810.00	16,980.00	38.25
208-000-653.05	RESERVATION FEES - FOX PARK	8,000.00	8,000.00	4,180.00	3,830.00	3,820.00	52.25
208-000-658.00	FINES & FEES	1,000.00	1,000.00	250.00	25.00	750.00	25.00
208-000-665.00	PARKS INTEREST EARNED	2,500.00	2,500.00	780.23	520.27	1,719.77	31.21
208-000-667.00	PAVILLION-SHAKEY	250.00	250.00	50.00	50.00	200.00	20.00
208-000-667.01	PAVILLION-KLEINKE	100.00	100.00	0.00	0.00	100.00	0.00
208-000-667.02	OUTSIDE STORAGE	3,000.00	3,000.00	2,775.00	0.00	225.00	92.50
208-000-667.03	INSIDE STORAGE	3,500.00	3,500.00	4,403.50	0.00	(903.50)	125.81
208-000-667.04	PAVILION - RIVER PARK	50.00	50.00	0.00	0.00	50.00	0.00
208-000-667.05	MASON PARK PAVILION	50.00	50.00	0.00	0.00	50.00	0.00
208-000-667.06	KAYAK RENTALS	750.00	750.00	10.00	0.00	740.00	1.33
208-000-671.00	SHAKEY LAKE LEASE SITES	65,000.00	65,000.00	65,040.00	2,500.00	(40.00)	100.06
208-000-671.01	KLEINKE LEASE SITES	2,000.00	2,000.00	7,500.00	0.00	(5,500.00)	375.00
208-000-674.02	DONATIONS - MUSIC IN THE PARK	1,000.00	1,000.00	0.00	0.00	1,000.00	0.00
208-000-675.00	MISCELLANEOUS RECEIPTS	0.00	0.00	167.61	0.00	(167.61)	100.00
208-000-699.00	BUDGETED USE OF UNSIGNATED FUND BALANC	0.00	48,500.00	0.00	0.00	48,500.00	0.00
208-000-699.01	BUDGETED USE OF DESIGNATED FUND BALANCE	0.00	5,441.88	0.00	0.00	5,441.88	0.00
208-000-699.02	OPERATING TRANSFER - GENERAL FUND	103,469.00	103,469.00	0.00	0.00	103,469.00	0.00
Total Dept 000 - NONE		482,419.00	542,360.88	229,533.26	134,999.27	312,827.62	42.32
TOTAL REVENUES		482,419.00	542,360.88	229,533.26	134,999.27	312,827.62	42.32
Expenditures							
Dept 751 - COUNTY PARKS							
208-751-704.00	SALARIES - FULL TIME	104,972.00	104,972.00	47,025.45	7,953.76	57,946.55	44.80
208-751-705.00	SALARIES - PART TIME	98,080.00	98,080.00	1,833.13	0.00	96,246.87	1.87
208-751-706.00	SALARIES - OVERTIME	9,500.00	9,500.00	4,252.93	788.57	5,247.07	44.77
208-751-712.00	HEALTH INSURANCE	29,662.00	29,662.00	16,820.64	2,308.52	12,841.36	56.71
208-751-712.01	DENTAL & VISION INSURANCE	2,244.00	2,244.00	1,294.50	172.60	949.50	57.69
208-751-713.00	LIFE INSURANCE	52.00	52.00	22.80	0.00	29.20	43.85
208-751-715.00	FICA PAYROLL TAXES	16,497.00	16,497.00	3,871.61	621.47	12,625.39	23.47
208-751-716.00	WORKERS' COMPENSATION INSURANCE	10,041.00	10,041.00	3,087.04	0.00	6,953.96	30.74
208-751-718.00	MERS - DEFINED CONTRIBUTION	3,949.00	3,949.00	2,041.71	341.02	1,907.29	51.70
208-751-718.01	MERS - DEFINED BENEFIT	34,022.00	34,022.00	14,175.75	2,835.15	19,846.25	41.67
208-751-727.00	OFFICE SUPPLIES	1,000.00	1,000.00	118.33	0.00	881.67	11.83
208-751-729.00	POSTAGE - PARKS	750.00	750.00	190.31	91.15	559.69	25.37
208-751-742.00	GAS & OIL	12,500.00	12,500.00	3,175.37	328.02	9,324.63	25.40
208-751-744.00	L.P. GAS	3,500.00	3,500.00	1,722.07	378.29	1,777.93	49.20
208-751-745.00	UNIFORMS	800.00	800.00	682.76	0.00	117.24	85.35
208-751-745.01	UNIFORMS/SUMMER HELP	350.00	350.00	0.00	0.00	350.00	0.00
208-751-755.00	GENERAL OPERATING SUPPLIES	5,000.00	5,000.00	948.13	121.48	4,051.87	18.96
208-751-755.01	JANITORIAL SUPPLIES	7,000.00	7,000.00	613.65	0.00	6,386.35	8.77

GL NUMBER	DESCRIPTION	2025-26	2025-26	YTD BALANCE	ACTIVITY FOR	AVAILABLE	% BDGT
		ORIGINAL BUDGET	AMENDED BUDGET	03/31/2026 NORM (ABNORM)	MONTH 03/31/26 INCR (DECR)	BALANCE NORM (ABNORM)	
Fund 208 - COUNTY PARKS							
Expenditures							
208-751-755.03	PASSES & ENVELOPES	2,250.00	2,250.00	1,255.40	0.00	994.60	55.80
208-751-755.06	PERMITS, LICENSES & INSPECTIONS	2,250.00	2,250.00	1,665.46	0.00	584.54	74.02
208-751-801.01	BACKGROUNDS, CHECKS, DRUG TESTS & PHYSI	1,250.00	1,250.00	74.00	74.00	1,176.00	5.92
208-751-801.04	POINT & PAY	7,500.00	7,500.00	567.25	40.54	6,932.75	7.56
208-751-801.06	FIREWOOD	2,500.00	2,500.00	0.00	0.00	2,500.00	0.00
208-751-850.00	TELEPHONE & INTERNET	4,000.00	4,000.00	1,540.18	22.81	2,459.82	38.50
208-751-860.00	PARKS COMMITTEE - PER DIEM/MILEAGE	1,750.00	1,750.00	650.05	165.25	1,099.95	37.15
208-751-880.00	PROGRAMING/RECREATION	1,000.00	1,000.00	94.92	0.00	905.08	9.49
208-751-880.01	MUSIC IN THE PARK - SHAKEY LAKES	1,500.00	1,500.00	0.00	0.00	1,500.00	0.00
208-751-901.00	ADVERTISING & M&M REGIONAL GUIDE	2,500.00	2,500.00	535.00	0.00	1,965.00	21.40
208-751-920.00	WATER TESTING	1,500.00	1,500.00	100.00	0.00	1,400.00	6.67
208-751-920.01	UTILITIES - ELECTRICITY	45,000.00	45,000.00	8,281.15	1,383.59	36,718.85	18.40
208-751-920.02	SOLID WASTE DISPOSAL	12,000.00	12,000.00	1,862.24	8.55	10,137.76	15.52
208-751-920.03	SEWER/SEPTIC	12,500.00	12,500.00	3,090.00	185.00	9,410.00	24.72
208-751-930.00	EQUIPMENT MAINTENANCE	7,500.00	7,500.00	3,269.47	187.89	4,230.53	43.59
208-751-930.01	FACILITY MAINTENANCE	10,000.00	10,000.00	4,237.14	1,009.99	5,762.86	42.37
208-751-930.02	GROUNDS MAINTENANCE	15,000.00	37,500.00	22,411.43	20,790.00	15,088.57	59.76
208-751-932.00	VEHICLE MAINTENANCE	5,000.00	5,000.00	5,280.58	1,113.61	(280.58)	105.61
208-751-956.01	NEW/REPLACEMENT EQUIPMENT	4,000.00	4,000.00	2,411.56	52.99	1,588.44	60.29
208-751-964.00	REFUNDS/REBATES	3,500.00	3,500.00	1,180.00	1,180.00	2,320.00	33.71
208-751-965.01	GRANT - DOCK EXPENSES	0.00	0.00	2,611.79	0.00	(2,611.79)	100.00
208-751-965.05	HANNAHVILLE GRANT - AEDS & ANTI CHOKING	0.00	2,571.00	2,571.63	0.00	(0.63)	100.02
208-751-967.01	SHAKEY LAKES BEACH IMPROVEMENT PROJECT	0.00	20,000.00	0.00	0.00	20,000.00	0.00
208-751-971.06	CAPITAL OUTLAY - CONCESSION STAND	0.00	2,870.88	0.00	0.00	2,870.88	0.00
208-751-971.09	CAPITAL OUTLAY - DUMP TRAILER	0.00	12,000.00	11,000.00	11,000.00	1,000.00	91.67
Total Dept 751 - COUNTY PARKS		482,419.00	542,360.88	176,565.43	53,154.25	365,795.45	32.55
TOTAL EXPENDITURES		482,419.00	542,360.88	176,565.43	53,154.25	365,795.45	32.55
Fund 208 - COUNTY PARKS:							
TOTAL REVENUES		482,419.00	542,360.88	229,533.26	134,999.27	312,827.62	42.32
TOTAL EXPENDITURES		482,419.00	542,360.88	176,565.43	53,154.25	365,795.45	32.55
NET OF REVENUES & EXPENDITURES		0.00	0.00	52,967.83	81,845.02	(52,967.83)	100.00

REVENUE AND EXPENDITURE REPORT FOR MENOMINEE COUNTY
 PERIOD ENDING 03/31/2026
 % Fiscal Year Completed: 49.86

GL NUMBER	DESCRIPTION	2025-26 ORIGINAL BUDGET	2025-26 AMENDED BUDGET	YTD BALANCE 03/31/2026 NORM (ABNORM)	ACTIVITY FOR MONTH 03/31/26 INCR (DECR)	AVAILABLE BALANCE NORM (ABNORM)	% BDGT USED
Fund 211 - PARK IMPROVEMENT FUND							
Revenues							
Dept 000 - NONE							
211-000-699.01	BUDGETED USE OF DESIGNATED FUND BALANCE	0.00	68,954.72	0.00	0.00	68,954.72	0.00
Total Dept 000 - NONE		0.00	68,954.72	0.00	0.00	68,954.72	0.00
TOTAL REVENUES		0.00	68,954.72	0.00	0.00	68,954.72	0.00
Expenditures							
Dept 751 - COUNTY PARKS							
211-751-730.00	SHAKEY CONCERT EXPENSES	0.00	667.19	0.00	0.00	667.19	0.00
211-751-971.08	MASON PARK BATHROOM	0.00	2,287.53	0.00	0.00	2,287.53	0.00
211-751-971.09	PARK ROAD IMPROVEMENTS	0.00	66,000.00	36,793.63	0.00	29,206.37	55.75
Total Dept 751 - COUNTY PARKS		0.00	68,954.72	36,793.63	0.00	32,161.09	53.36
TOTAL EXPENDITURES		0.00	68,954.72	36,793.63	0.00	32,161.09	53.36
Fund 211 - PARK IMPROVEMENT FUND:							
TOTAL REVENUES		0.00	68,954.72	0.00	0.00	68,954.72	0.00
TOTAL EXPENDITURES		0.00	68,954.72	36,793.63	0.00	32,161.09	53.36
NET OF REVENUES & EXPENDITURES		0.00	0.00	(36,793.63)	0.00	36,793.63	100.00
TOTAL REVENUES - ALL FUNDS		482,419.00	611,315.60	229,533.26	134,999.27	381,782.34	37.55
TOTAL EXPENDITURES - ALL FUNDS		482,419.00	611,315.60	213,359.06	53,154.25	397,956.54	34.90
NET OF REVENUES & EXPENDITURES		0.00	0.00	16,174.20	81,845.02	(16,174.20)	100.00

Fund 208 COUNTY PARKS

GL Number	Description	Balance
*** Assets ***		
208-000-001.00	CASH	157,038.61
208-000-001.36	SNBT PARKS 1023 CH	186,178.44
208-000-004.00	IMPREST CASH	300.00
Total Assets		343,517.05
*** Liabilities ***		
208-000-226.00	FOX PARK CAMPING FEES	36,430.00
Total Liabilities		36,430.00
*** Fund Balance ***		
208-000-390.00	FUND BALANCE	248,677.34
208-000-393.00	DESIGNATED FUND BALANCE	5,441.88
Total Fund Balance		254,119.22
Beginning Fund Balance		254,119.22
Net of Revenues VS Expenditures		52,967.83
Ending Fund Balance		307,087.05
Total Liabilities And Fund Balance		343,517.05

Fund 211 PARK IMPROVEMENT FUND

GL Number	Description	Balance
*** Assets ***		
211-000-001.00	CASH	37,057.93
Total Assets		37,057.93
*** Liabilities ***		
Total Liabilities		0.00
*** Fund Balance ***		
211-000-390.00	FUND BALANCE	4,896.87
211-000-393.03	DESIGNATED FUND BALANCE	68,954.69
Total Fund Balance		73,851.56
Beginning Fund Balance		73,851.56
Net of Revenues VS Expenditures		(36,793.63)
Ending Fund Balance		37,057.93
Total Liabilities And Fund Balance		37,057.93

Date: 5-1-2026 to 12-1-2026

Site	May, 2026		Jun, 2026		Jul, 2026		Aug, 2026		Sep, 2026		Oct, 2026		Nov, 2026		All	
	#	Total	#	Total	#	Total	#	Total	#	Total	#	Total	#	Total	#	Total
Fox Park - Site # 2	1	\$160.00	4	\$340.00	6	\$630.00	4	\$340.00	2	\$200.00	-	-	-	-	17	\$1,670.00
Fox Park - Site # 3	1	\$160.00	4	\$340.00	5	\$620.00	5	\$340.00	2	\$230.00	-	-	-	-	17	\$1,690.00
Fox Park - Site # 4	1	\$160.00	1	\$100.00	2	\$290.00	-	-	1	\$100.00	-	-	-	-	5	\$650.00
Fox Park - Site # 5	2	\$290.00	4	\$400.00	5	\$490.00	5	\$650.00	2	\$200.00	-	-	-	-	18	\$2,030.00
Fox Park - Site # 6	2	\$290.00	4	\$400.00	6	\$720.00	4	\$370.00	3	\$330.00	-	-	-	-	19	\$2,110.00
Fox Park - Site # 7	-	-	1	\$100.00	2	\$230.00	2	\$200.00	2	\$200.00	-	-	-	-	7	\$730.00
Fox Park - Site # 8	1	\$280.00	4	\$490.00	6	\$720.00	5	\$470.00	2	\$230.00	-	-	-	-	18	\$2,190.00
Fox Park - Site # 9	2	\$200.00	6	\$570.00	7	\$730.00	6	\$630.00	3	\$330.00	-	-	-	-	24	\$2,460.00
Fox Park - Site # 10	1	\$100.00	7	\$480.00	9	\$580.00	4	\$370.00	2	\$200.00	-	-	-	-	23	\$1,730.00
Fox Park - Site # 11	-	-	1	\$100.00	3	\$170.00	1	\$100.00	1	\$130.00	-	-	-	-	6	\$500.00
Fox Park - Site # 12	1	\$100.00	6	\$410.00	7	\$760.00	7	\$610.00	2	\$230.00	-	-	-	-	23	\$2,110.00
Fox Park - Site # 13	-	-	2	\$350.00	2	\$230.00	1	\$100.00	-	-	-	-	-	-	5	\$680.00
Fox Park - Site # 14	2	\$230.00	6	\$810.00	8	\$770.00	7	\$820.00	3	\$630.00	-	-	-	-	26	\$3,260.00
Fox Park - Site # 15	-	-	1	\$250.00	-	-	1	\$130.00	-	-	-	-	-	-	2	\$380.00
Fox Park - Site # 16	2	\$260.00	8	\$800.00	6	\$690.00	5	\$770.00	3	\$300.00	-	-	-	-	24	\$2,820.00
Fox Park - Site # 17A	1	\$70.00	1	\$310.00	3	\$240.00	3	\$300.00	1	\$70.00	-	-	-	-	9	\$990.00
Fox Park - Site # 17B	-	-	1	\$100.00	4	\$460.00	4	\$400.00	1	\$70.00	-	-	-	-	10	\$1,030.00
Fox Park - Site # 18A	1	\$100.00	6	\$750.00	7	\$760.00	9	\$900.00	3	\$210.00	-	-	-	-	26	\$2,720.00
Fox Park - Site # 18B	3	\$240.00	8	\$610.00	7	\$640.00	8	\$740.00	3	\$240.00	-	-	-	-	29	\$2,470.00
Fox Park - Site # 19	4	\$370.00	9	\$560.00	8	\$890.00	8	\$830.00	5	\$470.00	1	\$70.00	-	-	35	\$3,190.00
Fox Park - Site # 20	6	\$600.00	8	\$770.00	10	\$1,030.00	11	\$790.00	7	\$730.00	3	\$300.00	-	-	45	\$4,220.00
Fox Park - Grand Total	31	\$3,610.00	92	\$9,040.00	113	\$11,650.00	100	\$9,860.00	48	\$5,100.00	4	\$370.00	-	-	388	\$39,630.00
Kleinke Park - Site # 1	1	\$45.00	1	\$120.00	7	\$535.00	4	\$360.00	2	\$170.00	-	-	-	-	15	\$1,230.00
Kleinke Park - Site # 2	-	-	-	-	6	\$765.00	2	\$270.00	1	\$100.00	-	-	-	-	9	\$1,135.00
Kleinke Park - Site # 3	-	-	1	\$120.00	5	\$990.00	2	\$280.00	-	-	-	-	-	-	8	\$1,390.00
Kleinke Park - Site # 4	1	\$90.00	1	\$115.00	5	\$630.00	3	\$330.00	-	-	-	-	-	-	10	\$1,165.00
Kleinke Park - Site # 5	2	\$90.00	-	-	4	\$570.00	2	\$220.00	-	-	-	-	-	-	8	\$880.00
Kleinke Park - Site # 6	-	-	3	\$360.00	5	\$730.00	1	\$130.00	1	\$100.00	-	-	-	-	10	\$1,320.00
Kleinke Park - Site # 7	-	-	3	\$340.00	5	\$670.00	3	\$295.00	1	\$100.00	-	-	-	-	12	\$1,405.00
Kleinke Park - Site # 10	-	-	1	\$180.00	4	\$850.00	1	\$90.00	-	-	-	-	-	-	6	\$1,120.00
Kleinke Park - Site # 11	1	\$210.00	2	\$280.00	6	\$780.00	2	\$250.00	1	\$190.00	-	-	-	-	12	\$1,710.00
Kleinke Park - Site # 12	-	-	2	\$250.00	3	\$350.00	-	-	-	-	-	-	-	-	5	\$600.00
Kleinke Park - Site # 13	-	-	3	\$320.00	3	\$380.00	-	-	-	-	-	-	-	-	6	\$700.00
Kleinke Park - Site # 14	-	-	1	\$180.00	3	\$260.00	1	\$40.00	-	-	-	-	-	-	5	\$480.00
Kleinke Park - Site # 15	-	-	-	-	4	\$395.00	2	\$230.00	-	-	-	-	-	-	6	\$625.00
Kleinke Park - Site # 16	-	-	2	\$230.00	3	\$425.00	1	\$100.00	-	-	-	-	-	-	6	\$755.00
Kleinke Park - Site # 17	-	-	2	\$200.00	4	\$620.00	2	\$250.00	-	-	-	-	-	-	8	\$1,070.00
Kleinke Park - Site # 18	-	-	2	\$260.00	6	\$790.00	5	\$460.00	-	-	-	-	-	-	13	\$1,510.00
Kleinke Park - Site # 19	2	\$220.00	7	\$845.00	8	\$1,150.00	4	\$910.00	4	\$460.00	-	-	-	-	25	\$3,585.00
Kleinke Park - Site # 20	-	-	6	\$940.00	7	\$990.00	5	\$530.00	4	\$240.00	-	-	-	-	22	\$2,700.00
Kleinke Park - Site # 21	2	\$195.00	5	\$640.00	6	\$965.00	5	\$505.00	5	\$370.00	-	-	-	-	23	\$2,675.00
Kleinke Park - Site # 22	1	\$115.00	4	\$460.00	8	\$1,000.00	5	\$540.00	3	\$220.00	-	-	-	-	21	\$2,335.00
Kleinke Park - Site # 23	2	\$205.00	7	\$885.00	6	\$985.00	5	\$535.00	2	\$310.00	-	-	-	-	22	\$2,920.00
Kleinke Park - Site # 24	3	\$335.00	6	\$640.00	9	\$1,030.00	7	\$730.00	3	\$400.00	-	-	-	-	28	\$3,135.00
Kleinke Park - Site # 25	3	\$360.00	4	\$540.00	8	\$765.00	10	\$890.00	2	\$210.00	-	-	-	-	27	\$2,765.00
Kleinke Park - Site # 26	3	\$410.00	5	\$900.00	3	\$555.00	6	\$765.00	2	\$530.00	-	-	-	-	19	\$3,160.00
Kleinke Park - Site # 27	2	\$310.00	5	\$860.00	4	\$740.00	8	\$950.00	3	\$500.00	1	\$150.00	-	-	23	\$3,510.00
Kleinke Park - Site # 28	3	\$365.00	6	\$770.00	8	\$920.00	6	\$805.00	2	\$420.00	-	-	-	-	25	\$3,280.00
Kleinke Park - Site # 29	2	\$320.00	5	\$555.00	8	\$945.00	6	\$940.00	3	\$300.00	-	-	-	-	24	\$3,060.00
Kleinke Park - Site # 30	3	\$255.00	6	\$745.00	7	\$1,055.00	6	\$1,090.00	2	\$140.00	-	-	-	-	24	\$3,285.00
Kleinke Park - Site # 31	3	\$470.00	7	\$685.00	10	\$1,320.00	4	\$1,020.00	3	\$650.00	-	-	-	-	27	\$4,145.00
Kleinke Park - Grand Total	34	\$3,995.00	97	\$12,420.00	165	\$22,160.00	108	\$13,515.00	44	\$5,410.00	1	\$150.00	-	-	449	\$57,650.00
River Park - Site #1	-	-	-	-	-	-	-	-	-	-	-	-	-	-	-	-
River Park - Site #2	2	\$120.00	-	-	2	\$100.00	-	-	-	-	-	-	-	-	4	\$220.00
River Park - Site #3	1	\$50.00	1	\$90.00	-	-	1	\$35.00	1	\$70.00	-	-	-	-	4	\$245.00
River Park - Site #4	1	\$35.00	-	-	-	-	-	-	-	-	-	-	-	-	1	\$35.00
River Park - Grand Total	4	\$205.00	1	\$90.00	2	\$100.00	1	\$35.00	1	\$70.00	-	-	-	-	9	\$500.00

Site	May, 2026		Jun, 2026		Jul, 2026		Aug, 2026		Sep, 2026		Oct, 2026		Nov, 2026		All	
	#	Total	#	Total	#	Total	#	Total	#	Total	#	Total	#	Total	#	Total
Shakey Lakes Park - Site # 2	1	\$70.00	-	-	2	\$520.00	1	\$70.00	-	-	-	-	-	-	4	\$660.00
Shakey Lakes Park - Site # 7	-	-	-	-	1	\$140.00	-	-	-	-	-	-	-	-	1	\$140.00
Shakey Lakes Park - Site # 11	1	\$100.00	-	-	1	\$130.00	-	-	-	-	-	-	-	-	2	\$230.00
Shakey Lakes Park - Site # 13	1	\$120.00	1	\$130.00	4	\$420.00	1	\$70.00	-	-	-	-	-	-	7	\$740.00
Shakey Lakes Park - Site # 14	1	\$130.00	-	-	2	\$280.00	1	\$70.00	-	-	-	-	-	-	4	\$480.00
Shakey Lakes Park - Site # 15	1	\$130.00	-	-	2	\$305.00	-	-	-	-	-	-	-	-	3	\$435.00
Shakey Lakes Park - Site # 16	1	\$140.00	-	-	1	\$40.00	1	\$130.00	-	-	-	-	-	-	3	\$310.00
Shakey Lakes Park - Site # 20	1	\$100.00	-	-	2	\$170.00	1	\$80.00	-	-	-	-	-	-	4	\$350.00
Shakey Lakes Park - Site # 21	1	\$100.00	-	-	1	\$100.00	1	\$80.00	-	-	-	-	-	-	3	\$280.00
Shakey Lakes Park - Site # 22	1	\$100.00	-	-	1	\$100.00	1	\$80.00	-	-	-	-	-	-	3	\$280.00
Shakey Lakes Park - Site # 23	1	\$100.00	-	-	1	\$100.00	1	\$80.00	-	-	-	-	-	-	3	\$280.00
Shakey Lakes Park - Site # 24	1	\$100.00	-	-	1	\$100.00	1	\$80.00	-	-	-	-	-	-	3	\$280.00
Shakey Lakes Park - Site # 25	1	\$100.00	-	-	1	\$140.00	2	\$260.00	1	\$110.00	-	-	-	-	5	\$610.00
Shakey Lakes Park - Site # 26	1	\$160.00	-	-	2	\$290.00	2	\$170.00	1	\$70.00	-	-	-	-	6	\$690.00
Shakey Lakes Park - Site # 27	1	\$160.00	-	-	3	\$270.00	2	\$230.00	1	\$130.00	1	\$70.00	-	-	8	\$860.00
Shakey Lakes Park - Site # 28	1	\$130.00	1	\$115.00	3	\$350.00	3	\$500.00	1	\$130.00	1	\$70.00	-	-	10	\$1,295.00
Shakey Lakes Park - Site # 29	1	\$130.00	-	-	3	\$520.00	3	\$470.00	1	\$130.00	1	\$70.00	-	-	9	\$1,320.00
Shakey Lakes Park - Site # 30	1	\$130.00	1	\$100.00	3	\$565.00	3	\$490.00	1	\$130.00	-	-	-	-	9	\$1,415.00
Shakey Lakes Park - Site # 31	1	\$180.00	-	-	4	\$590.00	2	\$860.00	1	\$100.00	-	-	-	-	8	\$1,730.00
Shakey Lakes Park - Site # 32	1	\$200.00	-	-	3	\$490.00	2	\$860.00	1	\$100.00	-	-	-	-	7	\$1,650.00
Shakey Lakes Park - Site # 33	1	\$150.00	-	-	3	\$510.00	1	\$240.00	1	\$130.00	1	\$100.00	-	-	7	\$1,130.00
Shakey Lakes Park - Site # 34	1	\$130.00	-	-	3	\$500.00	1	\$240.00	1	\$130.00	1	\$70.00	-	-	7	\$1,070.00
Shakey Lakes Park - Site # 35	1	\$130.00	-	-	3	\$380.00	-	-	1	\$130.00	1	\$70.00	-	-	6	\$710.00
Shakey Lakes Park - Site # 36	1	\$190.00	-	-	2	\$340.00	1	\$270.00	1	\$190.00	-	-	-	-	5	\$990.00
Shakey Lakes Park - Site # 37	1	\$160.00	-	-	1	\$160.00	1	\$100.00	1	\$160.00	-	-	-	-	4	\$580.00
Shakey Lakes Park - Site # 38	1	\$80.00	2	\$210.00	3	\$220.00	-	-	1	\$100.00	-	-	-	-	7	\$610.00
Shakey Lakes Park - Site # 39	1	\$120.00	3	\$450.00	2	\$140.00	-	-	1	\$220.00	-	-	-	-	7	\$930.00
Shakey Lakes Park - Site # 41	1	\$100.00	-	-	3	\$330.00	1	\$180.00	-	-	-	-	-	-	5	\$610.00
Shakey Lakes Park - Site # 42	1	\$100.00	-	-	2	\$250.00	1	\$180.00	-	-	-	-	-	-	4	\$530.00
Shakey Lakes Park - Site # 43	1	\$120.00	-	-	1	\$150.00	1	\$180.00	-	-	-	-	-	-	3	\$450.00
Shakey Lakes Park - Site # 44	-	-	-	-	2	\$250.00	-	-	-	-	-	-	-	-	2	\$250.00
Shakey Lakes Park - Site # 45	1	\$115.00	-	-	3	\$580.00	-	-	-	-	-	-	-	-	4	\$695.00
Shakey Lakes Park - Site # 46	1	\$100.00	-	-	4	\$580.00	-	-	1	\$100.00	-	-	-	-	6	\$780.00
Shakey Lakes Park - Site # 49	1	\$130.00	1	\$80.00	2	\$250.00	1	\$100.00	-	-	-	-	-	-	5	\$560.00
Shakey Lakes Park - Site # 50	1	\$100.00	3	\$405.00	4	\$430.00	1	\$130.00	1	\$100.00	-	-	-	-	10	\$1,165.00
Shakey Lakes Park - Site # 51	1	\$100.00	3	\$390.00	3	\$420.00	-	-	1	\$100.00	-	-	-	-	8	\$1,010.00
Shakey Lakes Park - Site # 52	1	\$100.00	1	\$80.00	3	\$340.00	1	\$100.00	-	-	-	-	-	-	6	\$620.00
Shakey Lakes Park - Site # 54	1	\$170.00	-	-	2	\$400.00	-	-	-	-	-	-	-	-	3	\$570.00
Shakey Lakes Park - Site # 55	2	\$270.00	2	\$200.00	4	\$660.00	-	-	1	\$130.00	-	-	-	-	9	\$1,260.00
Shakey Lakes Park - Site # 59	1	\$120.00	1	\$250.00	4	\$570.00	1	\$70.00	-	-	-	-	-	-	7	\$1,010.00
Shakey Lakes Park - Site # 60	1	\$90.00	-	-	-	-	-	-	1	\$70.00	-	-	-	-	2	\$160.00
Shakey Lakes Park - Site # 61	-	-	-	-	1	\$150.00	-	-	-	-	-	-	-	-	1	\$150.00
Shakey Lakes Park - Site # 62	1	\$70.00	2	\$150.00	1	\$150.00	-	-	1	\$100.00	-	-	-	-	5	\$470.00
Shakey Lakes Park - Site # 63	1	\$220.00	3	\$420.00	2	\$235.00	-	-	1	\$100.00	-	-	-	-	7	\$975.00
Shakey Lakes Park - Site # 66	5	\$430.00	3	\$630.00	4	\$660.00	2	\$230.00	2	\$230.00	-	-	-	-	16	\$2,180.00
Shakey Lakes Park - Site # 67	1	\$120.00	-	-	2	\$275.00	1	\$100.00	-	-	-	-	-	-	4	\$495.00
Shakey Lakes Park - Site # 68	1	\$130.00	1	\$140.00	2	\$290.00	-	-	-	-	-	-	-	-	4	\$560.00
Shakey Lakes Park - Site # 69	1	\$90.00	3	\$750.00	3	\$430.00	1	\$200.00	-	-	-	-	-	-	8	\$1,470.00
Shakey Lakes Park - Site # 70	2	\$220.00	4	\$370.00	4	\$480.00	1	\$160.00	-	-	-	-	-	-	11	\$1,230.00
Shakey Lakes Park - Site # 71	-	-	2	\$220.00	4	\$410.00	1	\$160.00	-	-	-	-	-	-	7	\$790.00
Shakey Lakes Park - Site # 72	1	\$140.00	2	\$260.00	2	\$170.00	1	\$310.00	-	-	-	-	-	-	6	\$880.00
Shakey Lakes Park - Site # 74	2	\$200.00	1	\$100.00	2	\$190.00	1	\$240.00	-	-	-	-	-	-	6	\$730.00
Shakey Lakes Park - Site # 75	3	\$250.00	1	\$100.00	3	\$390.00	1	\$40.00	-	-	-	-	-	-	8	\$780.00
Shakey Lakes Park - Site # 77	-	-	2	\$300.00	-	-	1	\$70.00	1	\$120.00	-	-	-	-	4	\$490.00
Shakey Lakes Park - Site # 78	1	\$100.00	1	\$120.00	1	\$120.00	1	\$70.00	1	\$140.00	-	-	-	-	5	\$550.00
Shakey Lakes Park - Site # 79	1	\$100.00	1	\$90.00	2	\$180.00	1	\$70.00	-	-	-	-	-	-	5	\$440.00
Shakey Lakes Park - Site # 80	1	\$90.00	1	\$80.00	1	\$130.00	2	\$140.00	-	-	-	-	-	-	5	\$440.00
Shakey Lakes Park - Site # 81	1	\$90.00	1	\$90.00	1	\$170.00	2	\$170.00	-	-	-	-	-	-	5	\$520.00

Site	May, 2026		Jun, 2026		Jul, 2026		Aug, 2026		Sep, 2026		Oct, 2026		Nov, 2026		All	
	#	Total	#	Total	#	Total	#	Total	#	Total	#	Total	#	Total	#	Total
Shakey Lakes Park - Site # 82	1	\$150.00	2	\$210.00	2	\$140.00	3	\$300.00	-	-	-	-	-	-	8	\$800.00
Shakey Lakes Park - Site # 83	1	\$130.00	2	\$170.00	1	\$70.00	2	\$680.00	1	\$100.00	-	-	-	-	7	\$1,150.00
Shakey Lakes Park - Site # 84	1	\$130.00	1	\$100.00	1	\$100.00	2	\$170.00	1	\$100.00	-	-	-	-	6	\$600.00
Shakey Lakes Park - Site # 85	2	\$270.00	2	\$260.00	-	-	2	\$170.00	2	\$260.00	-	-	-	-	8	\$960.00
Shakey Lakes Park - Site # 86	1	\$170.00	2	\$340.00	-	-	1	\$70.00	2	\$220.00	1	\$100.00	-	-	7	\$900.00
Shakey Lakes Park - Site # 96	-	-	-	-	-	-	-	-	-	-	-	-	-	-	-	-
Shakey Lakes Park - Site # 97	-	-	-	-	-	-	-	-	-	-	-	-	-	-	-	-
Shakey Lakes Park - Site # 98	-	-	-	-	-	-	-	-	-	-	-	-	-	-	-	-
Shakey Lakes Park - Site # 99	-	-	-	-	-	-	-	-	-	-	-	-	-	-	-	-
Shakey Lakes Park - Site # B1	1	\$130.00	1	\$170.00	-	-	1	\$130.00	-	-	-	-	-	-	3	\$430.00
Shakey Lakes Park - Site # B2	1	\$130.00	2	\$630.00	1	\$100.00	-	-	-	-	-	-	-	-	4	\$860.00
Shakey Lakes Park - Site # B3	2	\$290.00	3	\$300.00	3	\$540.00	2	\$360.00	1	\$100.00	-	-	-	-	11	\$1,590.00
Shakey Lakes Park - Site # B4	1	\$130.00	2	\$180.00	3	\$530.00	2	\$340.00	1	\$100.00	-	-	-	-	9	\$1,280.00
Shakey Lakes Park - Site # B5	1	\$150.00	4	\$300.00	3	\$350.00	3	\$390.00	1	\$100.00	1	\$70.00	-	-	13	\$1,360.00
Shakey Lakes Park - Site # B6	1	\$150.00	3	\$330.00	3	\$440.00	3	\$330.00	-	-	-	-	-	-	10	\$1,250.00
Shakey Lakes Park - Site # B7	1	\$100.00	3	\$330.00	3	\$420.00	3	\$330.00	-	-	-	-	-	-	10	\$1,180.00
Shakey Lakes Park - Site # B8	3	\$310.00	-	-	2	\$450.00	1	\$130.00	-	-	-	-	-	-	6	\$890.00
Shakey Lakes Park - Site # B9	3	\$300.00	-	-	2	\$480.00	1	\$130.00	-	-	-	-	-	-	6	\$910.00
Shakey Lakes Park - Site # B10	1	\$100.00	1	\$280.00	1	\$160.00	-	-	-	-	-	-	-	-	3	\$540.00
Shakey Lakes Park - Site # B11	1	\$80.00	2	\$380.00	-	-	-	-	-	-	-	-	-	-	3	\$460.00
Shakey Lakes Park - Site # B12	1	\$120.00	2	\$380.00	-	-	-	-	-	-	-	-	-	-	3	\$500.00
Shakey Lakes Park - Site # CA1	-	-	2	\$170.00	2	\$170.00	1	\$270.00	-	-	-	-	-	-	5	\$610.00
Shakey Lakes Park - Site # CA2	-	-	2	\$170.00	1	\$80.00	1	\$290.00	-	-	-	-	-	-	4	\$540.00
Shakey Lakes Park - Site # CA3	1	\$160.00	1	\$80.00	2	\$270.00	-	-	1	\$100.00	-	-	-	-	5	\$610.00
Shakey Lakes Park - Site # CA4	1	\$130.00	1	\$120.00	3	\$290.00	-	-	1	\$100.00	-	-	-	-	6	\$640.00
Shakey Lakes Park - Site # CA5	1	\$160.00	1	\$100.00	2	\$250.00	1	\$240.00	1	\$150.00	-	-	-	-	6	\$900.00
Shakey Lakes Park - Site # CA6	-	-	1	\$150.00	2	\$305.00	1	\$130.00	1	\$150.00	-	-	-	-	5	\$735.00
Shakey Lakes Park - Site # CA7	1	\$100.00	2	\$210.00	2	\$340.00	2	\$390.00	1	\$150.00	-	-	-	-	8	\$1,190.00
Shakey Lakes Park - Site # CA8	1	\$100.00	2	\$460.00	2	\$410.00	1	\$220.00	1	\$150.00	-	-	-	-	7	\$1,340.00
Shakey Lakes Park - Site # CA9	1	\$100.00	2	\$450.00	4	\$590.00	1	\$70.00	1	\$120.00	-	-	-	-	9	\$1,330.00
Shakey Lakes Park - Site # CA10	1	\$100.00	1	\$310.00	3	\$310.00	1	\$80.00	2	\$420.00	-	-	-	-	8	\$1,220.00
Shakey Lakes Park - Site # P1	-	-	-	-	-	-	-	-	-	-	-	-	-	-	-	-
Shakey Lakes Park - Site # P2	-	-	-	-	-	-	-	-	-	-	-	-	-	-	-	-
Shakey Lakes Park - Site # P3	-	-	-	-	1	\$70.00	-	-	-	-	-	-	-	-	1	\$70.00
Shakey Lakes Park - Site # P4	-	-	1	\$110.00	1	\$170.00	-	-	-	-	-	-	-	-	2	\$280.00
Shakey Lakes Park - Site # P5	-	-	-	-	1	\$60.00	-	-	-	-	-	-	-	-	1	\$60.00
Shakey Lakes Park - Site # P6	-	-	-	-	-	-	-	-	-	-	-	-	-	-	-	-
Shakey Lakes Park - Site # P7	-	-	-	-	-	-	-	-	-	-	-	-	-	-	-	-
Shakey Lakes Park - Site # P8	-	-	-	-	1	\$50.00	-	-	-	-	-	-	-	-	1	\$50.00
Shakey Lakes Park - Site # P9	-	-	-	-	1	\$70.00	-	-	-	-	-	-	-	-	1	\$70.00
Shakey Lakes Park - Site # P10	-	-	-	-	1	\$50.00	-	-	-	-	-	-	-	-	1	\$50.00
Shakey Lakes Park - Site # VA1	2	\$230.00	3	\$290.00	2	\$220.00	1	\$130.00	1	\$130.00	-	-	-	-	9	\$1,000.00
Shakey Lakes Park - Site # VA2	1	\$100.00	-	-	2	\$480.00	-	-	1	\$100.00	-	-	-	-	4	\$680.00
Shakey Lakes Park - Site # VA3	1	\$100.00	1	\$70.00	3	\$590.00	-	-	1	\$100.00	-	-	-	-	6	\$860.00
Shakey Lakes Park - Site # VA4	1	\$100.00	2	\$170.00	2	\$340.00	-	-	1	\$160.00	-	-	-	-	6	\$770.00
Shakey Lakes Park - Site # VA5	1	\$260.00	2	\$170.00	3	\$410.00	-	-	1	\$100.00	-	-	-	-	7	\$940.00
Shakey Lakes Park - Site # VA6	2	\$270.00	-	-	4	\$500.00	1	\$310.00	-	-	-	-	-	-	7	\$1,080.00
Shakey Lakes Park - Site # VA7	-	-	1	\$100.00	3	\$270.00	-	-	1	\$170.00	-	-	-	-	5	\$540.00
Shakey Lakes Park - Grand Total	100	\$11,955.00	104	\$13,720.00	203	\$27,585.00	92	\$13,990.00	50	\$6,230.00	8	\$620.00	-	-	557	\$74,100.00

Date: 5-1-2025 to 12-1-2025

Site	May, 2025		Jun, 2025		Jul, 2025		Aug, 2025		Sep, 2025		Oct, 2025		Nov, 2025		All	
	#	Total	#	Total	#	Total	#	Total	#	Total	#	Total	#	Total	#	Total
Fox Park - Site # 1	-	-	-	-	-	-	-	-	-	-	-	-	-	-	-	-
Fox Park - Site # 2	4	\$290.00	10	\$575.00	12	\$845.00	14	\$765.00	6	\$305.00	2	\$95.00	-	-	48	\$2,875.00
Fox Park - Site # 3	3	\$255.00	10	\$575.00	13	\$805.00	11	\$735.00	8	\$455.00	1	\$35.00	-	-	46	\$2,860.00
Fox Park - Site # 4	1	\$135.00	3	\$180.00	13	\$780.00	5	\$525.00	1	\$35.00	1	\$35.00	-	-	24	\$1,690.00
Fox Park - Site # 5	2	\$170.00	10	\$650.00	10	\$850.00	13	\$770.00	7	\$520.00	5	\$225.00	-	-	47	\$3,185.00
Fox Park - Site # 6	4	\$265.00	7	\$545.00	17	\$910.00	13	\$695.00	6	\$510.00	2	\$95.00	-	-	49	\$3,020.00
Fox Park - Site # 7	-	-	3	\$280.00	5	\$650.00	10	\$625.00	3	\$155.00	2	\$70.00	-	-	23	\$1,780.00
Fox Park - Site # 8	5	\$325.00	7	\$520.00	11	\$810.00	11	\$860.00	10	\$575.00	4	\$215.00	-	-	48	\$3,305.00
Fox Park - Site # 9	4	\$80.00	9	\$540.00	13	\$855.00	10	\$740.00	5	\$350.00	5	\$225.00	-	-	46	\$2,790.00
Fox Park - Site # 10	2	\$145.00	7	\$470.00	10	\$825.00	11	\$835.00	4	\$215.00	1	\$60.00	-	-	35	\$2,550.00
Fox Park - Site # 11	1	-\$75.00	4	\$390.00	5	\$625.00	6	\$360.00	2	\$95.00	-	-	-	-	18	\$1,395.00
Fox Park - Site # 12	4	\$240.00	8	\$555.00	11	\$825.00	12	\$685.00	9	\$440.00	3	\$155.00	-	-	47	\$2,900.00
Fox Park - Site # 13	1	\$35.00	6	\$475.00	10	\$600.00	12	\$450.00	2	\$120.00	-	-	-	-	31	\$1,680.00
Fox Park - Site # 14	5	\$275.00	12	\$635.00	11	\$700.00	16	\$825.00	12	\$685.00	5	\$225.00	-	-	61	\$3,345.00
Fox Park - Site # 15	4	\$165.00	3	\$355.00	9	\$465.00	11	\$500.00	2	\$95.00	1	\$60.00	-	-	30	\$1,640.00
Fox Park - Site # 16	6	\$360.00	6	\$835.00	10	\$690.00	10	\$900.00	11	\$115.00	3	\$155.00	-	-	46	\$3,055.00
Fox Park - Site # 17A	2	\$95.00	3	\$305.00	7	\$495.00	9	\$440.00	2	\$95.00	-	-	-	-	23	\$1,430.00
Fox Park - Site # 17B	1	\$85.00	8	\$630.00	8	\$580.00	11	\$560.00	4	\$265.00	-	-	-	-	32	\$2,120.00
Fox Park - Site # 18A	4	\$240.00	12	\$795.00	13	\$795.00	10	\$740.00	9	\$540.00	7	\$260.00	-	-	55	\$3,370.00
Fox Park - Site # 18B	5	\$300.00	12	\$770.00	10	\$825.00	14	\$890.00	8	\$520.00	5	\$95.00	-	-	54	\$3,400.00
Fox Park - Site # 19	5	\$265.00	12	\$530.00	13	\$905.00	14	\$890.00	13	\$485.00	5	\$350.00	-	-	62	\$3,425.00
Fox Park - Site # 20	4	\$315.00	14	\$915.00	7	\$720.00	9	\$865.00	11	\$860.00	9	\$565.00	-	-	54	\$4,240.00
Fox Park - Grand Total	67	\$3,965.00	166	\$11,525.00	218	\$15,555.00	232	\$14,655.00	135	\$7,435.00	61	\$2,920.00	-	-	879	\$56,055.00
Kleinke Park - Site # 1	5	\$315.00	7	\$555.00	9	\$770.00	6	\$870.00	8	\$615.00	3	\$150.00	-	-	38	\$3,275.00
Kleinke Park - Site # 2	2	\$165.00	3	\$235.00	10	\$805.00	7	\$815.00	4	\$210.00	1	\$40.00	-	-	27	\$2,270.00
Kleinke Park - Site # 3	2	\$85.00	6	\$480.00	10	\$475.00	8	\$820.00	8	\$455.00	3	\$120.00	-	-	37	\$2,435.00
Kleinke Park - Site # 4	2	\$165.00	5	\$625.00	6	\$1,000.00	7	\$465.00	2	\$130.00	1	\$40.00	-	-	23	\$2,425.00
Kleinke Park - Site # 5	2	\$170.00	3	\$260.00	9	\$765.00	12	\$805.00	4	\$280.00	1	\$40.00	-	-	31	\$2,320.00
Kleinke Park - Site # 6	3	\$210.00	4	\$290.00	7	\$650.00	8	\$700.00	3	\$280.00	1	\$60.00	-	-	26	\$2,190.00
Kleinke Park - Site # 7	4	\$270.00	5	\$335.00	11	\$965.00	9	\$725.00	4	\$295.00	2	\$110.00	-	-	35	\$2,700.00
Kleinke Park - Site # 9	-	-	-	-	-	-	-	-	-	-	-	-	-	-	-	-
Kleinke Park - Site # 10	1	\$85.00	6	\$650.00	6	\$585.00	11	\$845.00	4	\$305.00	1	\$40.00	-	-	29	\$2,510.00
Kleinke Park - Site # 11	1	\$100.00	5	\$360.00	6	\$485.00	10	\$685.00	4	\$275.00	1	\$70.00	-	-	27	\$1,975.00
Kleinke Park - Site # 12	2	\$160.00	4	\$270.00	9	\$735.00	8	\$475.00	3	\$275.00	1	\$40.00	-	-	27	\$1,955.00
Kleinke Park - Site # 13	1	\$105.00	3	\$225.00	8	\$485.00	10	\$785.00	3	\$205.00	-	-	-	-	25	\$1,805.00
Kleinke Park - Site # 14	1	\$100.00	5	\$410.00	6	\$545.00	10	\$730.00	4	\$265.00	1	\$205.00	-	-	27	\$2,255.00
Kleinke Park - Site # 15	1	\$105.00	5	\$405.00	9	\$625.00	9	\$750.00	4	\$245.00	1	\$85.00	-	-	29	\$2,215.00
Kleinke Park - Site # 16	2	\$180.00	7	\$380.00	5	\$570.00	13	\$650.00	4	\$335.00	1	\$35.00	-	-	32	\$2,150.00
Kleinke Park - Site # 17	3	\$275.00	9	\$565.00	8	\$615.00	10	\$835.00	5	\$395.00	5	\$305.00	-	-	40	\$2,990.00
Kleinke Park - Site # 18	3	\$200.00	8	\$585.00	8	\$720.00	10	\$730.00	6	\$455.00	3	\$120.00	-	-	38	\$2,810.00
Kleinke Park - Site # 19	10	\$630.00	10	\$940.00	12	\$995.00	11	\$825.00	12	\$905.00	4	\$575.00	-	-	59	\$4,870.00
Kleinke Park - Site # 20	4	\$285.00	9	\$695.00	11	\$1,065.00	7	\$775.00	7	\$505.00	3	\$255.00	-	-	41	\$3,580.00
Kleinke Park - Site # 21	5	\$425.00	13	\$710.00	15	\$1,025.00	14	\$990.00	5	\$500.00	5	\$290.00	-	-	57	\$3,940.00
Kleinke Park - Site # 22	5	\$415.00	7	\$1,030.00	7	\$705.00	16	\$1,255.00	10	\$365.00	3	\$170.00	-	-	48	\$3,940.00
Kleinke Park - Site # 23	9	\$470.00	8	\$915.00	12	\$1,035.00	12	\$845.00	10	\$760.00	3	\$270.00	-	-	54	\$4,295.00
Kleinke Park - Site # 24	4	\$290.00	10	\$795.00	12	\$1,070.00	11	\$940.00	7	\$670.00	5	-\$70.00	-	-	49	\$3,695.00
Kleinke Park - Site # 25	3	\$305.00	9	\$940.00	9	\$1,085.00	10	\$885.00	5	\$485.00	2	\$130.00	-	-	38	\$3,830.00
Kleinke Park - Site # 26	7	\$480.00	9	\$795.00	9	\$845.00	9	\$780.00	7	\$580.00	5	\$295.00	-	-	46	\$3,775.00
Kleinke Park - Site # 27	4	\$350.00	8	\$1,045.00	5	\$640.00	9	\$870.00	10	\$790.00	5	\$290.00	-	-	41	\$3,985.00
Kleinke Park - Site # 28	2	\$270.00	10	\$1,040.00	9	\$855.00	8	\$810.00	18	\$1,185.00	6	\$380.00	-	-	53	\$4,540.00
Kleinke Park - Site # 29	3	\$355.00	8	\$795.00	10	\$1,020.00	11	\$1,030.00	12	\$870.00	3	\$235.00	-	-	47	\$4,305.00
Kleinke Park - Site # 30	4	\$330.00	4	\$645.00	10	\$950.00	9	\$965.00	11	\$725.00	4	\$235.00	-	-	42	\$3,850.00
Kleinke Park - Site # 31	8	\$550.00	12	\$1,210.00	4	\$555.00	10	\$940.00	13	\$750.00	8	\$400.00	-	-	55	\$4,405.00
Kleinke Park - Grand Total	103	\$7,845.00	202	\$18,185.00	252	\$22,640.00	285	\$23,595.00	197	\$14,110.00	82	\$4,915.00	-	-	1121	\$91,290.00
Kleinke Park - Pavilion - Pavilion	1	\$60.00	1	\$60.00	-	-	-	-	-	-	-	-	-	-	2	\$120.00
Kleinke Park - Pavilion - Grand Total	1	\$60.00	1	\$60.00	-	-	-	-	-	-	-	-	-	-	2	\$120.00
Mason Park - Pavilion - Pavilion	-	-	1	\$60.00	-	-	2	\$120.00	-	-	-	-	-	-	3	\$180.00
Mason Park - Pavilion - Grand Total	-	-	1	\$60.00	-	-	2	\$120.00	-	-	-	-	-	-	3	\$180.00
River Park - Site #1	3	\$155.00	4	\$170.00	7	\$265.00	6	\$210.00	4	\$180.00	2	\$60.00	-	-	26	\$1,040.00
River Park - Site #2	6	\$275.00	6	\$500.00	11	\$550.00	11	\$470.00	6	\$280.00	5	\$160.00	-	-	45	\$2,235.00
River Park - Site #3	6	\$270.00	6	\$390.00	11	\$460.00	11	\$405.00	7	\$340.00	3	\$120.00	-	-	44	\$1,985.00
River Park - Site #4	5	\$240.00	6	\$185.00	8	\$420.00	7	\$295.00	3	\$125.00	1	\$50.00	-	-	30	\$1,315.00
River Park - Grand Total	20	\$940.00	22	\$1,245.00	37	\$1,695.00	35	\$1,380.00	20	\$925.00	11	\$390.00	-	-	145	\$6,575.00
River Park - Pavilion - Pavilion	-	-	-	-	1	\$60.00	-	-	-	-	-	-	-	-	1	\$60.00
River Park - Pavilion - Grand Total	-	-	-	-	1	\$60.00	-	-	-	-	-	-	-	-	1	\$60.00

Site	May, 2025		Jun, 2025		Jul, 2025		Aug, 2025		Sep, 2025		Oct, 2025		Nov, 2025		All	
	#	Total	#	Total	#	Total	#	Total	#	Total	#	Total	#	Total	#	Total
Shakey Lakes Park - Site # 1	-	-	-	-	-	-	-	-	-	-	-	-	-	-	-	-
Shakey Lakes Park - Site # 2	1	\$85.00	2	\$160.00	6	\$495.00	5	\$435.00	-	-	-	-	-	-	14	\$1,175.00
Shakey Lakes Park - Site # 3	-	-	-	-	-	-	-	-	-	-	-	-	-	-	-	-
Shakey Lakes Park - Site # 4	-	-	-	-	-	-	-	-	-	-	-	-	-	-	-	-
Shakey Lakes Park - Site # 5	-	-	-	-	-	-	-	-	-	-	-	-	-	-	-	-
Shakey Lakes Park - Site # 6	-	-	-	-	-	-	-	-	-	-	-	-	-	-	-	-
Shakey Lakes Park - Site # 7	1	\$110.00	1	\$60.00	5	\$500.00	4	\$330.00	-	-	1	\$60.00	-	-	12	\$1,060.00
Shakey Lakes Park - Site # 8	-	-	-	-	-	-	-	-	-	-	-	-	-	-	-	-
Shakey Lakes Park - Site # 9	-	-	-	-	-	-	-	-	-	-	-	-	-	-	-	-
Shakey Lakes Park - Site # 10	-	-	-	-	-	-	-	-	-	-	-	-	-	-	-	-
Shakey Lakes Park - Site # 11	1	\$105.00	1	\$105.00	4	\$385.00	3	\$190.00	-	-	1	\$70.00	-	-	10	\$855.00
Shakey Lakes Park - Site # 12	-	-	-	-	-	-	-	-	-	-	-	-	-	-	-	-
Shakey Lakes Park - Site # 13	1	\$115.00	3	\$260.00	7	\$635.00	5	\$360.00	1	\$80.00	1	\$70.00	-	-	18	\$1,520.00
Shakey Lakes Park - Site # 14	1	\$85.00	2	-\$15.00	4	\$375.00	2	\$215.00	-	-	1	\$60.00	-	-	10	\$720.00
Shakey Lakes Park - Site # 15	1	\$110.00	1	\$115.00	3	\$285.00	3	\$165.00	-	-	1	\$60.00	-	-	9	\$735.00
Shakey Lakes Park - Site # 16	2	\$155.00	2	\$300.00	4	\$415.00	3	\$235.00	-	-	1	\$60.00	-	-	12	\$1,165.00
Shakey Lakes Park - Site # 17	-	-	-	-	-	-	-	-	-	-	-	-	-	-	-	-
Shakey Lakes Park - Site # 18	-	-	-	-	-	-	-	-	-	-	-	-	-	-	-	-
Shakey Lakes Park - Site # 19	-	-	-	-	-	-	-	-	-	-	-	-	-	-	-	-
Shakey Lakes Park - Site # 20	2	\$165.00	3	\$410.00	3	\$270.00	2	\$180.00	1	\$190.00	-	-	-	-	11	\$1,215.00
Shakey Lakes Park - Site # 21	1	\$85.00	2	\$175.00	4	\$385.00	5	\$425.00	1	\$180.00	-	-	-	-	13	\$1,250.00
Shakey Lakes Park - Site # 22	1	\$140.00	2	\$160.00	4	\$380.00	4	\$375.00	-	-	-	-	-	-	11	\$1,055.00
Shakey Lakes Park - Site # 23	1	\$130.00	1	\$105.00	5	\$480.00	5	\$370.00	-	-	-	-	-	-	12	\$1,085.00
Shakey Lakes Park - Site # 24	1	\$85.00	2	\$120.00	4	\$355.00	4	\$370.00	-	-	-	-	-	-	11	\$930.00
Shakey Lakes Park - Site # 25	1	\$110.00	3	\$350.00	4	\$395.00	3	\$285.00	-	-	1	\$60.00	-	-	12	\$1,200.00
Shakey Lakes Park - Site # 26	2	\$215.00	4	\$435.00	3	\$345.00	4	\$310.00	-	-	2	\$130.00	-	-	15	\$1,435.00
Shakey Lakes Park - Site # 27	2	\$210.00	3	\$325.00	4	\$430.00	3	\$230.00	-	-	1	\$60.00	-	-	13	\$1,255.00
Shakey Lakes Park - Site # 28	1	\$90.00	3	\$455.00	3	\$475.00	5	\$425.00	1	\$85.00	1	\$60.00	-	-	14	\$1,590.00
Shakey Lakes Park - Site # 29	2	\$190.00	4	\$505.00	4	\$425.00	3	\$285.00	-	-	1	\$60.00	-	-	14	\$1,465.00
Shakey Lakes Park - Site # 30	3	\$305.00	2	\$325.00	4	\$475.00	3	\$290.00	-	-	1	\$60.00	-	-	13	\$1,455.00
Shakey Lakes Park - Site # 31	2	\$145.00	3	\$440.00	4	\$435.00	3	\$320.00	-	-	1	\$70.00	-	-	13	\$1,410.00
Shakey Lakes Park - Site # 32	1	\$110.00	3	\$455.00	4	\$390.00	4	\$390.00	-	-	1	\$115.00	-	-	13	\$1,460.00
Shakey Lakes Park - Site # 33	1	\$110.00	2	\$470.00	4	\$415.00	3	\$320.00	-	-	1	\$85.00	-	-	11	\$1,400.00
Shakey Lakes Park - Site # 34	1	\$110.00	5	\$370.00	6	\$410.00	5	\$450.00	-	-	1	\$60.00	-	-	18	\$1,400.00
Shakey Lakes Park - Site # 35	3	\$280.00	4	\$585.00	7	\$440.00	5	\$365.00	-	-	1	\$60.00	-	-	20	\$1,730.00
Shakey Lakes Park - Site # 36	1	\$160.00	2	\$200.00	5	\$635.00	3	\$405.00	-	-	1	\$40.00	-	-	12	\$1,440.00
Shakey Lakes Park - Site # 37	1	\$215.00	4	\$285.00	4	\$400.00	4	\$465.00	-	-	1	\$40.00	-	-	14	\$1,405.00
Shakey Lakes Park - Site # 38	2	\$175.00	3	\$210.00	5	\$420.00	5	\$375.00	-	-	-	-	-	-	15	\$1,180.00
Shakey Lakes Park - Site # 39	2	\$275.00	4	\$265.00	5	\$330.00	4	\$425.00	-	-	-	-	-	-	15	\$1,295.00
Shakey Lakes Park - Site # 40	-	-	-	-	-	-	-	-	-	-	-	-	-	-	-	-
Shakey Lakes Park - Site # 41	1	\$85.00	3	\$455.00	6	\$380.00	5	\$590.00	-	-	-	-	-	-	15	\$1,510.00
Shakey Lakes Park - Site # 42	1	\$85.00	2	\$340.00	4	\$390.00	4	\$380.00	-	-	-	-	-	-	11	\$1,195.00
Shakey Lakes Park - Site # 43	1	\$85.00	3	\$315.00	6	\$575.00	2	\$170.00	-	-	-	-	-	-	12	\$1,145.00
Shakey Lakes Park - Site # 44	1	\$60.00	-	-	5	\$515.00	3	\$300.00	-	-	-	-	-	-	9	\$875.00
Shakey Lakes Park - Site # 45	1	\$110.00	3	\$310.00	6	\$700.00	6	\$445.00	-	-	-	-	-	-	16	\$1,565.00
Shakey Lakes Park - Site # 46	1	\$85.00	2	\$235.00	4	\$400.00	4	\$525.00	-	-	-	-	-	-	11	\$1,245.00
Shakey Lakes Park - Site # 47	-	-	-	-	-	-	-	-	-	-	-	-	-	-	-	-
Shakey Lakes Park - Site # 48	-	-	-	-	-	-	-	-	-	-	-	-	-	-	-	-
Shakey Lakes Park - Site # 49	2	\$225.00	3	\$495.00	5	\$535.00	3	\$495.00	1	\$100.00	1	\$70.00	-	-	15	\$1,920.00
Shakey Lakes Park - Site # 50	6	\$410.00	4	\$440.00	5	\$555.00	7	\$155.00	2	\$65.00	1	\$85.00	-	-	25	\$1,710.00
Shakey Lakes Park - Site # 51	1	\$115.00	3	\$610.00	7	\$520.00	4	\$350.00	2	\$250.00	1	\$60.00	-	-	18	\$1,905.00
Shakey Lakes Park - Site # 52	1	\$115.00	2	\$165.00	7	\$435.00	3	\$330.00	2	\$200.00	-	-	-	-	15	\$1,245.00
Shakey Lakes Park - Site # 53	-	-	-	-	-	-	-	-	-	-	-	-	-	-	-	-
Shakey Lakes Park - Site # 54	3	\$300.00	4	\$350.00	6	\$740.00	5	\$350.00	1	\$60.00	-	-	-	-	19	\$1,800.00
Shakey Lakes Park - Site # 55	2	\$170.00	4	\$580.00	4	\$610.00	4	\$440.00	3	\$255.00	3	\$280.00	-	-	20	\$2,335.00
Shakey Lakes Park - Site # 56	-	-	-	-	-	-	-	-	-	-	-	-	-	-	-	-
Shakey Lakes Park - Site # 57	-	-	-	-	-	-	-	-	-	-	-	-	-	-	-	-
Shakey Lakes Park - Site # 58	-	-	-	-	-	-	-	-	-	-	-	-	-	-	-	-
Shakey Lakes Park - Site # 59	2	\$155.00	5	\$330.00	4	\$545.00	6	\$465.00	1	\$70.00	2	\$95.00	-	-	20	\$1,660.00
Shakey Lakes Park - Site # 60	1	\$110.00	4	\$245.00	5	\$440.00	4	\$180.00	1	\$80.00	1	\$60.00	-	-	16	\$1,115.00
Shakey Lakes Park - Site # 61	2	\$145.00	3	\$230.00	4	\$630.00	4	\$340.00	-	-	-	-	-	-	13	\$1,345.00
Shakey Lakes Park - Site # 62	1	\$85.00	5	\$455.00	6	\$470.00	6	\$385.00	1	\$70.00	-	-	-	-	19	\$1,465.00
Shakey Lakes Park - Site # 63	1	\$85.00	5	\$410.00	5	\$635.00	4	\$325.00	1	\$85.00	-	-	-	-	16	\$1,540.00
Shakey Lakes Park - Site # 64	-	-	-	-	-	-	-	-	-	-	-	-	-	-	-	-
Shakey Lakes Park - Site # 65	-	-	-	-	-	-	-	-	-	-	-	-	-	-	-	-
Shakey Lakes Park - Site # 66	6	\$365.00	4	\$385.00	9	\$750.00	6	\$670.00	4	\$575.00	1	\$70.00	-	-	30	\$2,815.00
Shakey Lakes Park - Site # 67	2	\$220.00	3	\$190.00	6	\$705.00	3	\$230.00	1	\$40.00	-	-	-	-	15	\$1,385.00

Site	May, 2025		Jun, 2025		Jul, 2025		Aug, 2025		Sep, 2025		Oct, 2025		Nov, 2025		All	
	#	Total	#	Total	#	Total	#	Total	#	Total	#	Total	#	Total	#	Total
Shakey Lakes Park - Site # 68	2	\$210.00	4	\$280.00	5	\$475.00	4	\$305.00	2	\$245.00	-	-	-	-	17	\$1,515.00
Shakey Lakes Park - Site # 69	5	\$405.00	4	\$340.00	7	\$805.00	7	\$455.00	3	\$215.00	2	\$355.00	-	-	28	\$2,575.00
Shakey Lakes Park - Site # 70	4	\$325.00	3	\$260.00	6	\$635.00	7	\$400.00	2	\$140.00	3	\$640.00	-	-	25	\$2,400.00
Shakey Lakes Park - Site # 71	5	\$325.00	3	\$295.00	5	\$595.00	7	\$400.00	3	\$305.00	2	\$480.00	-	-	25	\$2,400.00
Shakey Lakes Park - Site # 72	1	\$105.00	3	\$315.00	5	\$415.00	5	\$405.00	-	-	-	-	-	-	14	\$1,240.00
Shakey Lakes Park - Site # 73	-	-	-	-	-	-	-	-	-	-	-	-	-	-	-	-
Shakey Lakes Park - Site # 74	1	\$105.00	4	\$285.00	5	\$1,085.00	5	\$370.00	-	-	2	\$160.00	-	-	17	\$2,005.00
Shakey Lakes Park - Site # 75	3	\$210.00	4	\$270.00	5	\$670.00	4	\$330.00	1	\$35.00	2	\$145.00	-	-	19	\$1,660.00
Shakey Lakes Park - Site # 76	-	-	-	-	-	-	-	-	-	-	-	-	-	-	-	-
Shakey Lakes Park - Site # 77	3	\$290.00	2	\$270.00	5	\$445.00	3	\$280.00	-	-	-	-	-	-	13	\$1,285.00
Shakey Lakes Park - Site # 78	1	\$110.00	1	\$85.00	5	\$530.00	3	\$275.00	1	\$70.00	-	-	-	-	11	\$1,070.00
Shakey Lakes Park - Site # 79	2	\$245.00	1	\$135.00	6	\$580.00	3	\$230.00	-	-	1	\$60.00	-	-	13	\$1,250.00
Shakey Lakes Park - Site # 80	1	\$110.00	2	\$215.00	7	\$665.00	4	\$360.00	-	-	1	\$60.00	-	-	15	\$1,410.00
Shakey Lakes Park - Site # 81	1	\$110.00	3	\$375.00	5	\$640.00	2	\$170.00	-	-	1	\$85.00	-	-	12	\$1,380.00
Shakey Lakes Park - Site # 82	1	\$110.00	2	\$120.00	5	\$850.00	2	\$245.00	-	-	1	\$85.00	-	-	11	\$1,410.00
Shakey Lakes Park - Site # 83	1	\$105.00	2	\$145.00	5	\$595.00	5	\$395.00	-	-	1	\$85.00	-	-	14	\$1,325.00
Shakey Lakes Park - Site # 84	1	\$105.00	2	\$200.00	4	\$410.00	5	\$485.00	-	-	1	\$85.00	-	-	13	\$1,285.00
Shakey Lakes Park - Site # 85	2	\$245.00	3	\$280.00	4	\$550.00	6	\$565.00	1	\$110.00	1	\$85.00	-	-	17	\$1,835.00
Shakey Lakes Park - Site # 86	1	\$105.00	3	\$305.00	3	\$375.00	5	\$440.00	1	\$60.00	-	-	-	-	13	\$1,285.00
Shakey Lakes Park - Site # 87	-	-	-	-	-	-	-	-	-	-	-	-	-	-	-	-
Shakey Lakes Park - Site # 88	-	-	-	-	-	-	-	-	-	-	-	-	-	-	-	-
Shakey Lakes Park - Site # 89	-	-	-	-	-	-	-	-	-	-	-	-	-	-	-	-
Shakey Lakes Park - Site # 90	-	-	-	-	-	-	-	-	-	-	-	-	-	-	-	-
Shakey Lakes Park - Site # 91	-	-	-	-	-	-	-	-	-	-	-	-	-	-	-	-
Shakey Lakes Park - Site # 92	-	-	-	-	-	-	-	-	-	-	-	-	-	-	-	-
Shakey Lakes Park - Site # 93	-	-	-	-	-	-	-	-	-	-	-	-	-	-	-	-
Shakey Lakes Park - Site # 94	-	-	-	-	-	-	-	-	-	-	-	-	-	-	-	-
Shakey Lakes Park - Site # 95	-	-	-	-	-	-	-	-	-	-	-	-	-	-	-	-
Shakey Lakes Park - Site # 96	1	\$130.00	3	\$240.00	5	\$575.00	3	\$215.00	-	-	-	-	-	-	12	\$1,160.00
Shakey Lakes Park - Site # 97	2	\$200.00	3	\$190.00	2	\$300.00	4	\$315.00	1	\$110.00	-	-	-	-	12	\$1,115.00
Shakey Lakes Park - Site # 98	1	\$110.00	2	\$195.00	6	\$655.00	2	\$145.00	-	-	-	-	-	-	11	\$1,105.00
Shakey Lakes Park - Site # 99	1	\$115.00	3	\$335.00	6	\$470.00	3	\$325.00	-	-	-	-	-	-	13	\$1,245.00
Shakey Lakes Park - Site # B1	2	\$195.00	1	\$85.00	7	\$655.00	4	\$405.00	3	\$305.00	-	-	-	-	17	\$1,645.00
Shakey Lakes Park - Site # B2	2	\$195.00	3	\$240.00	7	\$655.00	5	\$405.00	4	\$290.00	2	\$145.00	-	-	23	\$1,930.00
Shakey Lakes Park - Site # B3	2	\$195.00	5	\$480.00	6	\$545.00	5	\$645.00	5	\$570.00	2	\$130.00	-	-	25	\$2,565.00
Shakey Lakes Park - Site # B4	1	\$135.00	5	\$530.00	6	\$480.00	5	\$525.00	1	\$85.00	2	\$190.00	-	-	20	\$1,945.00
Shakey Lakes Park - Site # B5	1	\$110.00	5	\$445.00	7	\$690.00	4	\$450.00	1	\$85.00	1	\$130.00	-	-	19	\$1,910.00
Shakey Lakes Park - Site # B6	3	\$310.00	5	\$360.00	7	\$550.00	7	\$755.00	1	\$85.00	-	-	-	-	23	\$2,060.00
Shakey Lakes Park - Site # B7	2	\$220.00	4	\$115.00	7	\$635.00	6	\$545.00	2	\$140.00	-	-	-	-	21	\$1,655.00
Shakey Lakes Park - Site # B8	2	\$225.00	2	\$185.00	5	\$690.00	4	\$295.00	-	-	-	-	-	-	13	\$1,395.00
Shakey Lakes Park - Site # B9	1	\$160.00	4	\$280.00	3	\$440.00	4	\$370.00	1	\$70.00	1	\$85.00	-	-	14	\$1,405.00
Shakey Lakes Park - Site # B10	1	\$135.00	3	\$280.00	4	\$315.00	4	\$315.00	2	\$285.00	-	-	-	-	14	\$1,330.00
Shakey Lakes Park - Site # B11	2	\$205.00	2	\$255.00	5	\$385.00	4	\$370.00	-	-	-	-	-	-	13	\$1,215.00
Shakey Lakes Park - Site # B12	2	\$215.00	3	\$315.00	5	\$365.00	4	\$360.00	1	\$70.00	-	-	-	-	15	\$1,325.00
Shakey Lakes Park - Site # CA1	1	\$85.00	4	\$330.00	7	\$440.00	4	\$395.00	1	\$60.00	-	-	-	-	17	\$1,310.00
Shakey Lakes Park - Site # CA2	3	\$225.00	2	\$155.00	6	\$825.00	4	\$420.00	1	\$85.00	1	\$85.00	-	-	17	\$1,795.00
Shakey Lakes Park - Site # CA3	1	\$85.00	2	\$220.00	5	\$410.00	4	\$395.00	1	\$60.00	-	-	-	-	13	\$1,170.00
Shakey Lakes Park - Site # CA4	3	\$190.00	5	\$350.00	5	\$515.00	5	\$600.00	1	\$60.00	-	-	-	-	19	\$1,715.00
Shakey Lakes Park - Site # CA5	4	\$520.00	4	\$235.00	4	\$470.00	4	\$345.00	2	\$145.00	1	\$60.00	-	-	19	\$1,775.00
Shakey Lakes Park - Site # CA6	1	\$135.00	3	\$245.00	5	\$490.00	3	\$310.00	1	\$85.00	-	-	-	-	13	\$1,265.00
Shakey Lakes Park - Site # CA7	1	\$85.00	2	\$140.00	5	\$570.00	4	\$365.00	2	\$130.00	-	-	-	-	14	\$1,290.00
Shakey Lakes Park - Site # CA8	1	\$105.00	3	\$215.00	6	\$610.00	3	\$305.00	-	-	-	-	-	-	13	\$1,235.00
Shakey Lakes Park - Site # CA9	1	\$115.00	3	\$255.00	5	\$690.00	2	\$305.00	1	\$60.00	1	\$60.00	-	-	13	\$1,485.00
Shakey Lakes Park - Site # CA10	2	\$25.00	4	\$370.00	6	\$650.00	4	\$440.00	2	\$145.00	-	-	-	-	18	\$1,630.00
Shakey Lakes Park - Site # P1	1	\$50.00	-	-	3	\$175.00	1	\$55.00	-	-	-	-	-	-	5	\$280.00
Shakey Lakes Park - Site # P2	1	\$60.00	1	\$40.00	3	\$200.00	1	\$25.00	-	-	-	-	-	-	6	\$325.00
Shakey Lakes Park - Site # P3	1	\$75.00	2	\$215.00	3	\$220.00	1	\$70.00	-	-	-	-	-	-	7	\$580.00
Shakey Lakes Park - Site # P4	2	\$115.00	2	\$170.00	5	\$405.00	3	\$120.00	1	\$25.00	-	-	-	-	13	\$835.00
Shakey Lakes Park - Site # P5	3	\$205.00	3	\$175.00	4	\$265.00	4	\$300.00	4	\$190.00	-	-	-	-	18	\$1,135.00
Shakey Lakes Park - Site # P6	-	-	1	\$90.00	2	\$150.00	2	\$95.00	1	\$40.00	-	-	-	-	6	\$375.00
Shakey Lakes Park - Site # P7	-	-	3	\$155.00	4	\$195.00	1	\$70.00	-	-	-	-	-	-	8	\$420.00
Shakey Lakes Park - Site # P8	1	\$75.00	3	\$185.00	4	\$200.00	3	\$155.00	4	\$150.00	-	-	-	-	15	\$765.00
Shakey Lakes Park - Site # P9	1	\$55.00	3	\$150.00	4	\$260.00	2	\$105.00	1	\$160.00	-	-	-	-	11	\$730.00
Shakey Lakes Park - Site # P10	1	\$55.00	5	\$235.00	2	\$160.00	3	\$140.00	3	\$150.00	-	-	-	-	14	\$740.00
Shakey Lakes Park - Site # VA1	4	\$560.00	8	\$630.00	8	\$725.00	5	\$535.00	2	\$95.00	1	\$60.00	-	-	28	\$2,605.00
Shakey Lakes Park - Site # VA2	3	\$205.00	3	\$225.00	5	\$675.00	4	\$315.00	1	\$60.00	1	\$60.00	-	-	17	\$1,540.00
Shakey Lakes Park - Site # VA3	3	\$190.00	3	\$245.00	4	\$585.00	4	\$355.00	1	\$60.00	1	\$85.00	-	-	16	\$1,520.00

Site	May, 2025		Jun, 2025		Jul, 2025		Aug, 2025		Sep, 2025		Oct, 2025		Nov, 2025		All	
	#	Total	#	Total	#	Total	#	Total	#	Total	#	Total	#	Total	#	Total
Shakey Lakes Park - Site # VA4	2	\$120.00	3	\$285.00	4	\$385.00	3	\$255.00	1	\$60.00	1	\$85.00	-	-	14	\$1,190.00
Shakey Lakes Park - Site # VA5	1	\$110.00	2	\$245.00	6	\$460.00	4	\$290.00	-	-	1	\$85.00	-	-	14	\$1,190.00
Shakey Lakes Park - Site # VA6	2	\$225.00	1	\$85.00	4	\$410.00	2	\$365.00	-	-	-	-	-	-	9	\$1,085.00
Shakey Lakes Park - Site # VA7	2	\$215.00	3	\$200.00	3	\$355.00	2	\$165.00	1	\$135.00	-	-	-	-	11	\$1,070.00
Shakey Lakes Park - Grand Total	182	\$17,040.00	310	\$28,720.00	520	\$52,130.00	412	\$35,960.00	92	\$7,615.00	64	\$5,585.00	-	-	1580	\$147,050.00
Shakey Lakes Park - Pavilions - Beach	-	-	4	\$240.00	1	\$60.00	1	\$60.00	-	-	-	-	-	-	6	\$360.00
Shakey Lakes Park - Pavilions - East	-	-	2	\$120.00	1	\$60.00	-	-	-	-	-	-	-	-	3	\$180.00
Shakey Lakes Park - Pavilions - West	-	-	-	-	2	\$220.00	-	-	-	-	-	-	-	-	2	\$220.00
Shakey Lakes Park - Pavilions - Grand Total	-	-	6	\$360.00	4	\$340.00	1	\$60.00	-	-	-	-	-	-	11	\$760.00
All - Grand Total	373	\$29,850.00	708	\$60,155.00	1032	\$92,420.00	967	\$75,770.00	444	\$30,085.00	218	\$13,810.00	-	-	3742	\$302,090.00



NEXT AGENDA ITEM

Jason Carviou

From: Keith Waloway <donotreply@dmistudios.com>
Sent: Wednesday, April 1, 2026 2:58 PM
To: Jason Carviou
Subject: Menominee County Contact Us - Administration - General Information

Email Address: keith@insworks.net

First Name: Keith

Last Name: Waloway

Address: 2042 Maple Ave Ste B

City: Marinette

State: Wisconsin

Zip Code: 54143

Phone Number: 7159239050

Fax Number:

Comments/Questions: Jason Carviou
Menominee County Administrator
839 10th Ave
Menominee, MI 49858

Dear Jason,

I am writing to you on behalf of the Marinette/Menominee Great Lakes Sportfishermen (MMGLSF) as their President. In particular the Stoney Point boat launch owned by the county. The MMGLSF has been very involved for over 30 years in the maintenance of this launch so it can remain usable to everyone and an important safety launch for rescues etc since it is the only launch between Cedar River and Menominee. Current club VP John Neilio has over 30 years of acquiring permits for various improvements and dredgings with the club paying for these permits, channel markers and other improvements.

2025 was no different as the water levels dropped to a point where launching any boat made it difficult because of the fall off at the end of the concrete pad. John wrote up a permit to use gravel at the end of the concrete pad so trailer tires wouldn't fall off the pad and cause damage and difficulty getting boats back out of the water etc. The channel is still deep enough to get out into the bay and will eventually need to be dredged again but it won't make a difference if the launch is still unusable. John estimates it will cost \$1,000 or less for this gravel fix.

John indicated to myself and the club members that he put in the effort to get this fix completed and presented the permit to you but no further action was taken on it. To be frank we are all very surprised this option wasn't immediately considered and acted upon! After all the county profits from launch fees and it is a popular launch. We do know budget constraints are always an issue and as always we are willing to help with costs of this project like we have always done in

the past, all we need is yours and the county's cooperation. All future improvements that John and the club will work on will not be done if we cannot get your cooperation on this much needed immediate fix. The permit will still be good all we need is your partnership for your own facility. The safety factor alone is worth the effort!

I welcome a return email or phone call with myself and John as soon as you can so we know how to notify people that are asking us about the status of the launch. It will get very busy soon if it is not usable and we will have no choice but to refer the upset boaters to you.

Sincerely,

Keith Waloway, President MMGLSF

STONY POINT BOAT LAUNCH
RAMP
CROSS SECTION

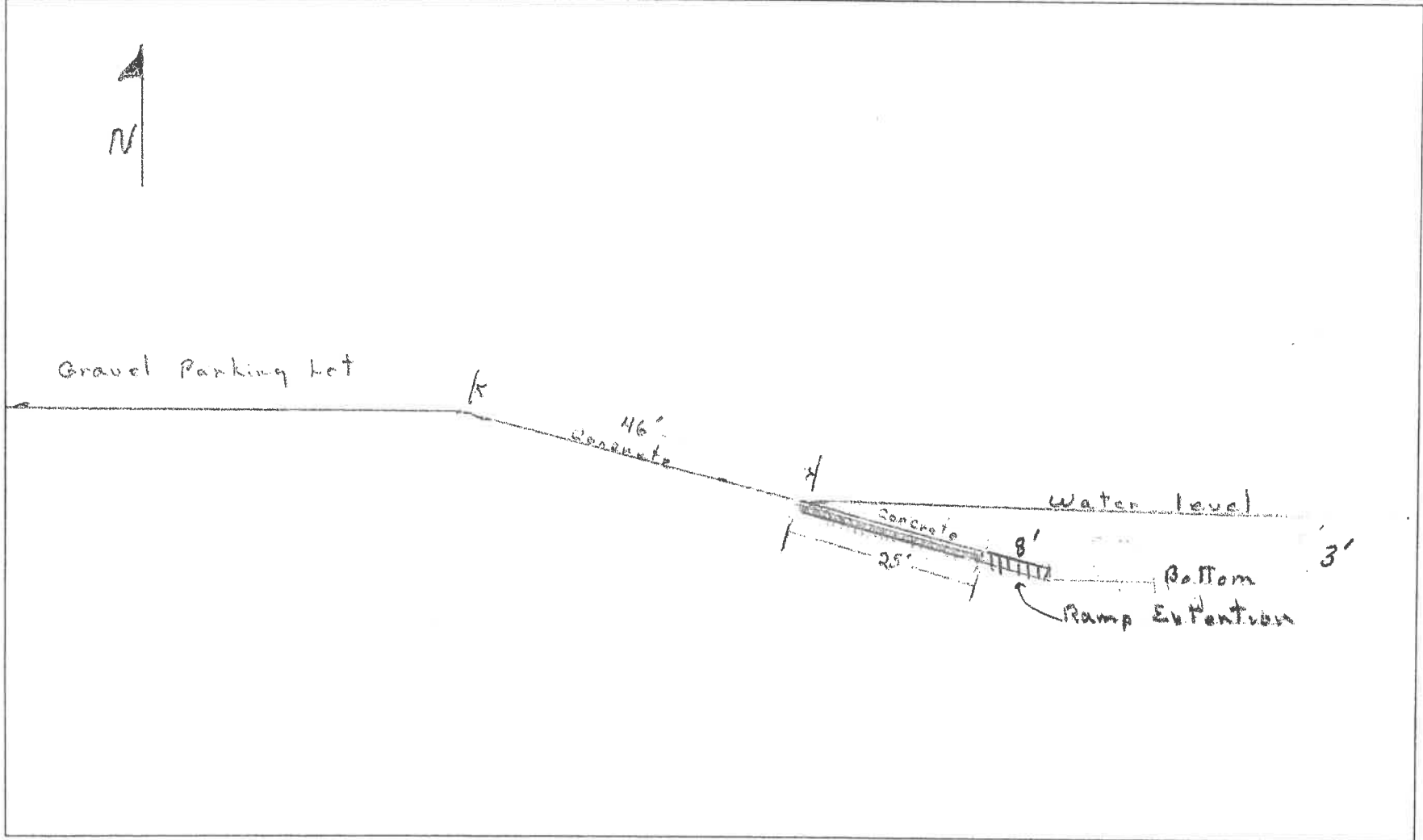

Scale 1" = 20'

STONY POINT BOAT LAUNCH
TOP VIEW

